

THE CUTTER GAS MOTORHOME



CUTLER

If you prefer a smaller Cutler, we offer two gas-powered models available on a Chevrolet chassis. Both offer Cutler's superior

livability features and give you the added spaciousness that can make your travels even more enjoyable.

Both heating and ducted roof air conditioning are controlled by a conveniently-placed thermostat.



Location of batteries behind the engine cover makes routine maintenance easier than ever. (30' and 34' only)



Alcoa aluminum wheels, standard on the Cutter 35' pusher, add to its good looks while providing a stronger, lightweight wheel. (Available February, 1998)



Exterior shower and service hook-ups are all readily accessible in the centrally located system.

Cutter is designed to provide maximum exterior storage capacity. Large, carpeted compartments with aluminum doors (two pass-through compartments in most models) allow you to carry everything you'll need and give you easy access to it as well.

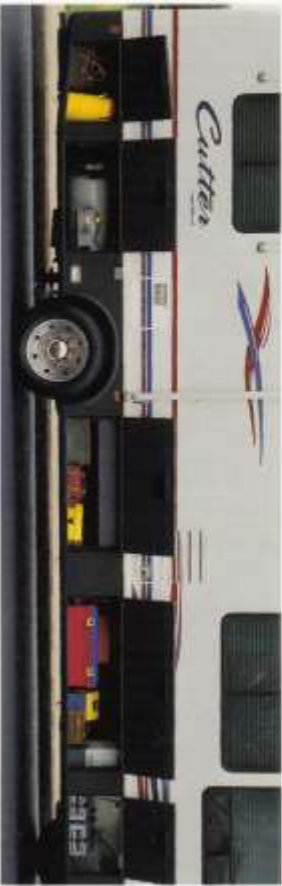

Optional twin beds available 30' and 34'

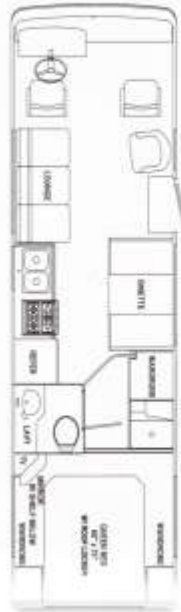

30' Gas-powered Cutter



34' Gas-powered Cutter



Cutter 35' Diesel Pusher shown with optional free-standing dinette



Cutter 35' Diesel Pusher Slide shown with optional free-standing dinette

- CH
- Alt
- Fre
- Bat
- Ber
- Aux
- Bat
- Aux
- Bat
- Bat
- Bat
- Bat
- Bat
- Bat
- Bus
- and
- Br
- Alc
- Rad
- Rad
- Spa
- Esh
- Full
- Rear
- Trail
- Trailer
- EX
- 4'8
- Fib
- Lam
- Und
- Aw
- Wh
- C S
- Bur
- Fib
- Doc
- Din
- Hoa
- Ete
- Fish
- and
- Apr
- Key
- Bec
- Ete
- Ete
- Fall
- "Du
- Low
- Pass
- Rear
- DR
- 19'
- ANY
- Aut
- Aut

THE CUTTER MOTORHOME STANDARD FEATURES AND OPTIONS

CHASSIS	30' 34'		35' 35'		DRIVERS COMPARTMENT	30' 34'		35' 35'		BEDROOM	30' 34'		35' 35'		APPLIANCES	30' 34'		35' 35'	
	Gas	Diesel	Gas	Diesel		Gas	Diesel	Gas	Diesel		Gas	Diesel	Gas	Diesel		Gas	Diesel	Gas	Diesel
Alternator—105 amp Chevy/100 amp Freightliner w/extra-dry isolator	S	S	S	S	Leather Driver and Co-pilot Seats w/Integrated 3-point Seat Belts w/Retractor Swivel & Reclining Mechanism	S	S	S	S	Patented Night Shades (optional)	S	S	S	S	Air Conditioners, (2) Ceiling-ducted	S	S	S	S
Battery Disconnect (optional)	S	S	S	S	Powered Driver Seat	S	S	S	S	Fan-Tastic™ Roof Vent w/Wall Thermostat and Rain Sensor	O	O	O	O	Carbon Monoxide Detector	S	S	S	S
Battery, Main (1)	S	S	S	S	Deluxe Side Panel: Driver/Passenger	O	O	O	O	Rear Exit Ladder	S	S	S	S	Fire Extinguisher	S	S	S	S
Auxiliary Batteries (2)	S	NA	NA	NA	Instrument Panel (optional)	S	S	S	S	Two Bed w/Night Stand	O	NA	NA	NA	Smoke Detector	S	S	S	S
Battery Main (2) on Freightliner Auxiliary (2)	NA	NA	S	S	Inverter 130-watt (split TV only)	O	O	NA	NA	Queen Bed w/Sheet Closets	O	O	S	S	LPG Detector	S	S	S	S
Backup Brezier	S	S	S	S	Rear Vision TV Monitor	O	O	NA	NA	APPLIANCES					Mobile Theater Surround-sound System Includes: VCR, CD Changer w/Remote and Remote for Stereo Deck	NA	NA	S*	S*
Paragaph Wipers w/Water Arm and Control Knob	S	S	S	S	2-v Accessory Power Ports (2) w/2-position Cigarettes	O	O	S	S	TV Accessory with Booster Includes: Cable hook-up, Telephone Hook-up and VCR Pre-amp	S	S	S	S	Video Cassette Player w/Light in Cabinet & VCC	O	O	NA	NA
Bright Wheel Studs	S	NA	NA	NA	Privacy Blinds/Curtain (imp sound)	S	S	S	S	13" Built-in TV in Bedroom	S	S	S	S	2-way Auto Refrigerator	S	S	S	S
Alcoa Aluminum Wheels	NA	NA	S*	S*	Emergency Start Solenoid (optional)	S	S	S	S	2-way Auto Refrigerator	S	S	S	S	2 Door/8 Cu. Ft.	S	S	S	S
Radium Tires	S	S	S	S	Front Overhead Cabinet	S	S	S	S	Slide-in side 10 cu. ft. 2-way Auto Refrigerator	NA	NA	O	O	3-burner Cooktop w/Oven	O	O	O	O
Spare Tire Winch and Tire Exhaust Brake	NA	NA	S	S	Beverage Tray	S	S	S	S	3-burner Cooktop w/Storage Drawers and Back Glass	O	O	O	O	3-burner Cooktop w/Storage Drawers and Back Glass	S	S	S	S
Full Air Brakes	NA	NA	S	S	Turn Signal, Cruise, Wipers/Washers	S	S	S	S	6-gal. DSJ Water Heater w/Mix-A-Jolt™	S	S	S	S		S	S	S	S
Rear Automatic Heater	S	S	NA	NA	GALLEY														
Trailer Hitch 400 HW/4,000 GVW	S	S	NA	NA	Bronze V-groove Mirrored front in Overhead Cabinets (over Bed 15")	S	S	S	S										
Trailer Hitch 500 HW/5,000 GVW	NA	NA	NA	NA	Connection Microwave	S	S	S	S										
EXTERIOR					Porcelain Sink with Sink Covers (2)	S	S	S	S										
4" Roof w/extra green Treatment	S	S	S	S	Water Purifier	S	S	S	S										
Fiberglass Finish	S	S	S	S	Diaper 36"	S	S	S	S										
Laminated Rock, Siderack and Floor Undercoating (over web only)	S	S	S	S	Free-standing Dinette w/2 Chairs (4 din. 23")	O	O	O	O										
Awning Rail, R.S. & C.S. w/Drain Edge Window Awnings (NA GVW)	S	S	S	S	Patented Flooring Galley Area	O	O	NA	NA										
C.S. Photo Awnings	S	S	S*	S*	Space Rack	S	S	NA	NA										
Bumpers, Integral w/ Front & Rear Fiberglass Cap	S	S	S	S	Corner™ Galley Top	S	S	S	S										
Docking Lights, Halogen	S	S	S	S	INTERIOR DECOR														
Driving Lamps, Halogen	S	S	S	S	Oak Cabinets	S	S	S	S										
Headlamps, Halogen	S	S	S	S	Oak Handwood Tables & Countertops w/No-riv Finish (large & small)	O	O	S	S										
Exterior Lighting Package includes: Patio Light, Utility Light, Step Light and Baggage Compartment Lights	S	S	S	S	Ceramic Tile Floor (red and white)	NA	NA	S*	S*										
Air Horns	NA	NA	S	S	Patented Day/Night Shades (large & small)	O	O	O	O										
Keyless Entry	O	O	S	S	Decorative Filigree	S	S	S	S										
Electric-keyed Dead Bolt (main door)	O	O	S	S	Vinyr Set Ceiling	S	S	S	S										
Electric-operated Entrance Step (optional)	S	S	S	S	BATHROOM														
Exterior Mirrors w/Remote Control	S	S	S	S	Bath Vent Powered (power #8 33')	S	S	S	S										
Exterior Water Service with Shut-off	S	S	S	S	Spright Shower	NA	S	S	S										
Full Slide Windows w/Tinted Glass	S	S	S	S	Chromed Brass Fixtures	S	S	S	S										
*Dual Pane Windows	TBD TBD	S	S	S	Large Mirrored Medicine Cabinet	S	S	S	S										
Leaking Jokes	O	O	S	S	One-piece Fiberglass Shower	S	S	S	S										
Pass-thru Trunk Storage	S	S	NA	NA	Single-pane Brass Shower Door	S	S	S	S										
Rear Ladder	S	S	S	S	Toilet "Porcelain"	NA	NA	S	S										
					Toilet w/Water Saver	S	S	NA	NA										
DRIVERS COMPARTMENT					BEDROOM														
19" TV in Dash w/telescope (110-watt)	S	S	S	S	Wardrobe, Lighted, Cash-drawn, Mirrored Oak Doors	S	S	S	S										
AM/FM Cassette, Digital w/4 Speakers	S	S	NA	NA	Plasma—hanging	S	S	S	S										
Auto. A/C with Side Window Defrost	S	S	S	S	Bedspread and Pillows	S	S	S	S										
Auxiliary Defroster Fans	S	S	S	S															

* Feature Available February 1998

SPECIFICATIONS	30'		34'		35'		35'	
	Cherry	Cherry	Freightliner	Freightliner	Diesel	Diesel	Diesel	Diesel
Chassis	Cherry	Cherry	Freightliner	Freightliner	Diesel	Diesel	Diesel	Diesel
Engine—Chevy Vortec	454	454	300 CAT	300 CAT				
Transmission	4-speed O.D.	4-speed O.D.	6-speed	6-speed				
Actual Length	30'2"	33'9"	35'4"	35'4"				
Exterior Width	101"	101"	101"	101"				
Exterior Height w/A/C	11'2"	11'2"	11'8"	11'8"				
Interior Height	78.5"	78.5"	78.5"	78.5"				
Interior Width	95"	95"	95"	95"				
Slide-out Room Dimensions	NA	NA	NA	16" x 15.5" x 65"				
GAWR, Front—Gross Axle Weight Rating	5,500	5,500	9,350	9,350				
GAWR, Rear—Gross Axle Weight Rating	11,000	11,000	17,000	17,000				
GAWR, TAG—Gross All Weight Rating (includes tongue 70% only)	NA	4,000	NA	NA				
GCWR—Gross Combined Weight Rating	21,000	21,000	31,350	31,350				
GVWR—Gross Vehicle Weight Rating	16,500	19,500	26,350	26,350				
UVW, Hand Queen—Vehicle Weight	14,270	15,580	19,580	20,470				
NCC—Net Carrying Capacity	2,230	3,920	6,770	5,880				
Wheelbase	190"	190"	228"	228"				
Fuel Tank	75	90	75	90				
LPG Tank (incl. 1105 w/g D. gas)	90	90	182	182				
Fresh Water Tank w/Drain Valve (gal)	60	63	63	60				
Grey Water Holding Tank (gal)	70	70	70	60				
Black Water Holding Tank (gal)	50	43	50	43				
Furnace BTU	35,000	35,000	35,000	35,000				
Exterior Storage Volume (cu. ft.)	120	146	130	95				

Specifications are subject to change without notice. Consult your distributor for details. P.S.